

LAG-4500

LAG Equipment proudly presents their latest refractory tear-out machine designed for safety and innovation.

Leading the industry in design and innovation, the LAG-4500 provides efficient and reliable refractory tear-out for Electric Arc Furnaces. Positioned on top of the furnace shell, the lining is removed quickly with minimum downtime. Multi-position legs allow the LAG-4500 to be fitted on most furnaces ranging from 75 to 350 tons. Exceptional reach of the hydraulic breaker allows the machine to clean the lower shell and around the taphole. Outfitted with various hammer attachment ends, the refractory lining can be pushed through the man-door of the furnace, allowing for faster clean-up. Operating via a radio control pendant, the LAG-4500 allows the operator to view and operate the machine at a safe distance.

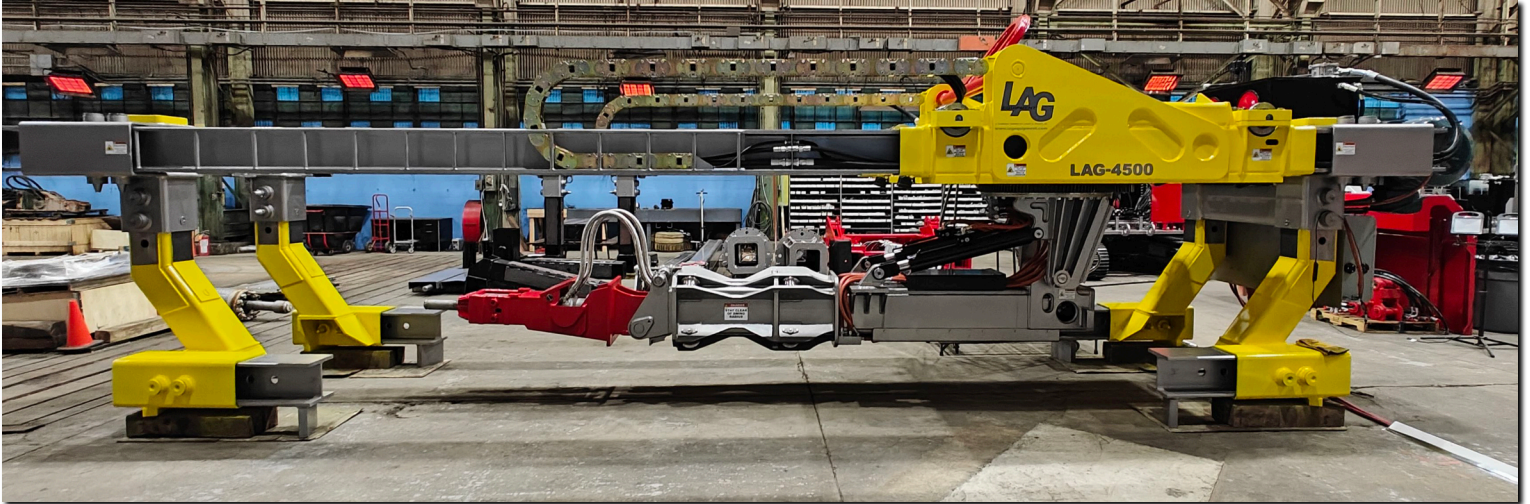

Key features:

- Hose and electrical supply lines within hose tracks on inside of travel beams
- Radio control pendant only, no tethered connection to machine
- Multi-positional leg settings to fit furnace shell
- Reinforced outer boom structure
- Reinforced trunnion structure
- Safety tie-offs for maintenance
- LED work lights



LAG
EQUIPMENT

LAG-4500

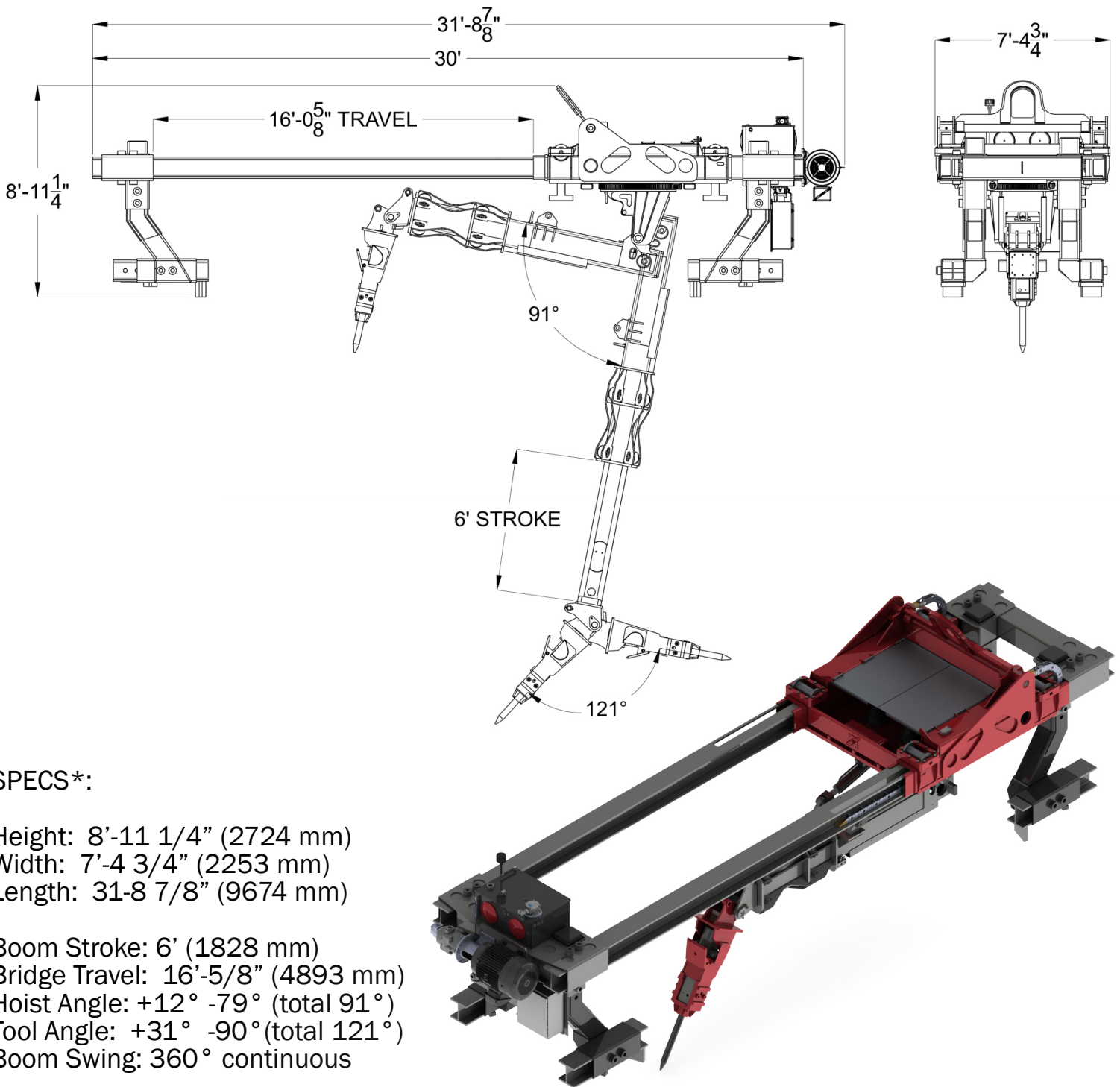

SPECS*:

Height: 8'-11 1/4" (2724 mm)

Width: 7'-4 3/4" (2253 mm)

Length: 31-8 7/8" (9674 mm)

Boom Stroke: 6' (1828 mm)

Bridge Travel: 16'-5/8" (4893 mm)

Hoist Angle: +12° -79° (total 91°)

Tool Angle: +31° -90° (total 121°)

Boom Swing: 360° continuous

To accommodate the array of furnace sizes, various boom sizes, leg heights and leg extensions are available.

*Specifications are subject to change per customer requirements

LAG Equipment
Company owned by Louis A. Grant, Jr.
4300 Commerce Circle, Trafford, PA 15085
412-798-6505 sales@lagequipment.com

